

Tender No. _____

Year : 2024-25

Shri Sharda Bhavan Education Society's
YESHWANT MAHAVIDYALAYA, NANDED



Tender form for:

1. Development of Computer Lab for PG Dept. for Yeshwant Mahavidyalaya, Nanded
2. Development of Computer Lab for UG Dept. and Smart Classroom for Yeshwant Mahavidyalaya, Nanded
3. Development of Innovation and Incubation Centre for Dept. of Electronics of Yeshwant Mahavidyalaya, Nanded

श्री शारदा भवन पञ्चकेशन सोसायटी संचलित,

यशवंत महाविद्यालय, नांदेड

अल्प मुदतीची निविदा सुचना

यशवंत महाविद्यालयातील वर्गखोल्यांचे रुपांतर (१) UG, PG विभागासाठी Computer Lab with Furniture/Modular Table व Smart Classroom with Furniture/Modular Table विकसित करणे तसेच (२) YCMOU च्या निधीअंतर्गत ICT Center with furniture/Modular Table विकसित करण्याच्या कामासाठी संबंधित विभागाचे नोंदणीकृत परवानाधारक व अशा प्रकारचे केलेल्या कामाचा अनुभव असलेले कंत्राटदार/फर्म यांच्याकडून या कामासाठी निविदा मागविण्यात येत आहेत. तरी इच्छुकांनी सदरील कामासाठीची कोरी निविदा महाविद्यालयाच्या कार्यालयातून दि.१६.०१.२०२५ ते २३.०१.२०२५ पर्यंत कार्यालयीन वेळेत निविदा किंमत रु.५००/- प्रत्येकी नापरतावा भरून कार्यालयातून खरेदी करावे. प्रत्येक निविदेसोबत रु.१०,०००/- Principal Yeshwant Mahavidyalaya, Nanded या नावाचा धनाकर्ष (DD) जोडणे आवश्यक आहे व भरलेल्या सीलबंद निविदा दि.२४.०१.२०२५ रोजी दुपारी ०१.०० वाजेपर्यंत कार्यालयात स्वीकारण्यात येतील. मुदतीनंतर आलेल्या निविदा स्वीकारण्यात येणार नाहीत. कोणतीही अथवा सर्व निविदा स्वीकारणे, नाकारणे अथवा रद्द करणे/बदल करण्याचा अधिकार प्रशासनाने राखून ठेवला आहे.

प्राचार्य, यशवंत महाविद्यालय, बाबा नगर, नांदेड

Shri Sharda Bhavan Education Society's
YESHWANT MAHAVIDYALAYA, NANDED

INSTRUCTIONS TO THE CONTRACTORS/FIRMS FOR THE WORK

The Contractor or firm has to comply with the following requirements while submitting the tender.

Envelope containing :

1. The Bankers cheque or DD of Nationalise Bank for the Earnest Money Deposit 1% of estimated amount.
2. Statement giving the list of work in hand and those completed during last two years detailing the authority, the cost of works and the stage of work etc.
3. List of technical personnel with the contractor or firm.
4. Conditional tenders will be rejected.

Tender offer will remain **valid for 60 days** from the date opening of the tender.

If the tendering contractor is a firm or company, they should produce all legal documents with the tender.

The Contractor is required to sign all the tender documents on each and every page including the attached to the tender set.

YESHWANT MAHAVIDYALAYA, NANDED

SPECIAL CONDITIONS

1. A schedule of probable quantities in respect of each work and a specification accompany these special conditions. The schedule of probable quantity is liable to alterations by omitting, deductions at the discretion of the consulting Engineer/College. Each tender should contain not only the rates but also the value of the each item should be total in order to show the aggregate value of the entire quotation. The employees does not undertake to carry out the whole of the work the plans and taken in the schedule of quantities and reserve the right to modify the same or any part there of the contractor shall not be allowed any compensation or damages for the work which is so dropped or cancelled by the employer.
2. The tender must obtain for himself on his own responsibility and at his own expenses all the information which may be necessary for the purpose of making a tendered for entering into a contract and must examine the drawings and must consider and inspect the site of the work and acquaint himself with all local conditions means of access to the work, nature of the work, and all matters appertaining there of the tendered should observe the specification of materials to be used in the work.
3. The contractor on starting the work shall furnish to the consulting Engineer and programme for carrying out the work stage in stipulated time. The record showing the progress of work weekly shall be maintained.
4. The owner will not give advance for the purchase of any material required for the work.
5. Security deposits shall be deducted from R.A. bills and retained. This deposit will be inclusive of Earnest money deposit, initial security deposit & return after the defect liability period.
6. The E.M.D. amount for selected tender will be converted as initial security deposit.
7. The contractor shall insure all his staff and workers against accidents as per the workers compensation Act the contractor shall obtain this policy within 08 days from the date of work orders.
8. The contractor shall also provide third party insurance cover as per clause of general conditions of contract.
9. The contractor will not be paid any extra rate more than the tender rate in case of increase in the quantities to any extent.
10. Tender containing erasures and alterations of the tender documents are liable to be rejected any corrections made by the tendered in his/their entries must be attested by him/them.
11. The works are required to be completed with in a period of **02 calendar months** from the date of issue of the work order.
12. It shall not be obligatory on the said authority to accept the lowest tender and no tender/contractor shall demand by any explanation for the cause of rejection of his/there quotation.
13. The authority for acceptance of the tender will rest the Central Purchase Committee/Principal, Yeshwant Mahavidyalaya, Nanded who does not bind himself to accept the lowest of any other tender not does he undertake to assign reasons for declining to consider any particular quotation.
14. If material supply by society, then recovery form bills will be: for steel = 65000/- per mt., for cement: 350 per bag.
15. All required material for the project should be got approved form the consultants/secretary/Principal in writing before execution of the work.
16. Use of material for this project.
17. Steel: Rajuri/Polad/Kalika, Cement: Ultratech+, Acc Concrete+, Ambuja for concrete work.
18. Plumbing: CPVC pipe, fitting-ISI mark standard as per approval by consultant.

Shri Sharda Bhavan Education Society's
YESHWANT MAHAVIDYALAYA, NANDED

Name of Work	Estimated Cost		Furniture Work - Quote rate as per design & drawing for 100Nos. with chair	
	Civil Work	Electrical Work	Providing & Making	Modular Table
Development of Computer Lab for PG Dept. for Yeshwant Mahavidyalaya, Nanded	Rs.2,92,153.00	Rs.2,52,852.00	Rate per Table	Rate per Table
We are ready to execute the above work % above/below the estimated rate				

Contractor/Firm Seal & Sign.

Shri Sharda Bhavan Education Society's
YESHWANT MAHAVIDYALAYA, NANDED

Name of Work	Estimated Cost		
	Civil Work	Electrical Work	Furniture Work with chair
Development of Computer Lab for UG Dept. and Smart Classroom for Yeshwant Mahavidyalaya, Nanded	Rs.4,29,364.00	Rs.1,35,193.00	----
We are ready to execute the above work % above/below the estimated rate			

Contractor/Firm Seal & Sign.

Shri Sharda Bhavan Education Society's
YESHWANT MAHAVIDYALAYA, NANDED

Name of Work	Estimated Cost		
	Civil Work	Electrical Work	Furniture Work with chair
Development of Innovation and Incubation Centre for Dept. of Electronics of Yeshwant Mahavidyalaya, Nanded	Rs.6,29,277.00	Rs.1,40,543/-	----
We are ready to execute the above work % above/below the estimated rate			

Contractor/Firm Seal & Sign.

NAME OF WORK :- DEVELOPMENT OF COMPOUTER LAB FOR PG OF YESHWANT MAHAVIDYALAYA, NANDED

ABSTRACT SHEET

Item	Description of Item	Qty	Unit	Rate		Amount
1	Removing ventilators and small windows with frame and stacking the materials with all leads, lifts etc. complete.	7.00	Sqm.	132.00	Rs.	924.00
2	Providing and laying in position flooring of telephone black / Amba White / Cat bary brown / Ruby red / Ocean Brown granite stone of approved shade and size 18 mm to 20 mm thick on bed 1:6 cement mortar including	5.81	Sqm.	4024.00	Rs.	23359.00
3	Providing & Fixing in position, Acoustical Ceiling made from Gypsum Plain Panels on approved heavy duty G.I. frame ceiling channels at 450 c to c, & intermediate channels not more than 1200 c to c, along with ply	79.90	Sqm.	1465.00	Rs.	117054.00
4	Providing and applying Two coats of wall care Putty on plastered surface and Ceiling and Walls to prepare surface	151.22	Sq.M.	90.00	Rs.	13610.00
5	Providing, fabricating and erecting at site of work the	0.17	MT	114831.00	Rs.	19843.00
6	Providing and applying plastic emulsion paint of approved quality, colour and shade to old and new surfaces in two coats	151.22	Sqm.	80.00	Rs.	12098.00
7	Providing and fixing in position. (as per I.S.1868 / 1982) Aluminium sliding window of two tracks with rectangular pipe having overall dimension 63.50	17.33	Sqm.	5479.00	Rs.	94924.00
8	Providing and applying two coats of flat oil paint of approved colour to the old structural steel work and iron work previously painted in building including scaffolding, if necessary,	17.33	Sqm.	85.00	Rs.	1473.00

9	Providing and fixing solid core flush door shutter in single leaf 32 mm thick decorative type of exterior grade as per detailed drawings approved face veneers	2.88	Sqm.	3079.00	Rs.	8868.00
				Total	Rs.	292153.00



**NAME OF WORK :- DEVELOPMENT OF COMPOUTER LAB FOR PG OF YESHWANT
MAHAVIDYALAYA, NANDED**

MEASUREMENT SHEET

Item	Removing ventilators and small windows with frame and stacking the materials with all leads, lifts						
No.1 :-	etc. complete.						
	7	x	1.00	x	1.00	=	<u>7.00</u>
							7.00 No
Item	Providing and laying in position flooring of telephone black / Amba White / Cat bary brown / Ruby						
No.2 :-	red / Ocean Brown granite stone of approved shade and size 18 mm to 20 mm thick on bed 1:6 cement mortar including cement floats striking joints, pointing in C.M. 1:3 curing and cleaning etc. complete.						
Window	7	x	1.00	x	0.45	x	1.5 = 4.73
Door	2	x	1.00	x	0.45	x	1.2 = <u>1.08</u>
							5.81 Cum.
Item	Providing & Fixing in position, Acoustical Ceiling made from Gypsum Plain Panels on approved						
No.3 :-	heavy duty G.I. frame ceiling channels at 450 c to c, & intermediate channels not more than 1200 c to c, along with ply wood forms suspended with Hangers from Roof, in front of 1000 Gsm synthetic wool 50 mm thick, with Paint, including cost of required Cut-Outs, decorative mouldings / finishing-items & Scaffolding, as per Architectural & Acoustical Design & Instructions & Complete in all aspects.including all materials labour,finishing etc complete						
	1	x	6.80	x	11.75	=	<u>79.90</u>
							79.90 Sq.M.
Item	Providing and applying Two coats of wall care Putty on plastered surface and Ceiling and						
No.4:-	Walls to prepare surface even and smooth of approved make, etc complete.						
			4.00	x	6.80	x	3.10 = 84.32
			2.00	x	11.75	x	3.10 = 72.85
	7		2.00	x	1.60	x	0.40 = 8.96
	7	x	1.00	x	1.50	x	0.40 = 4.20
	2	x	1.00	x	2.40	x	0.40 = 1.92
	1	x	1.00	x	1.20	x	0.40 = <u>0.48</u>
							172.73 Sq.m.
	Deduction						
	1	x	7.00	x	1.50	x	1.50 = 15.75
	1	x	2.00	x	1.20	x	2.40 = <u>5.76</u>
							21.51 Sq.m.
							Net Qty = 151.22 Sq.m.
Item	Providing, fabricating and erecting at site of work the tubular steel structure (shed) as per						
No.5 :-	standard design and specifications having various spans in between trusses and in multiples of standard length of bays as specified as per standard specifications, inclusive of cost of steel						
Pipe for ceiling	1	x	4.00	x	4.00	x	2.70 = 43.20
							<u>43.20</u>
					43.20	4.00	172.80 Kg
							0.17 MT
Item	Providing and applying plastic emulsion paint of approved quality, colour and shade to old and						
No.6:-	new surfaces in two coats including scaffolding, preparing the surface. (excluding the						
							Qty. As per putty = 151.22
							151.22 Sqm.
Item	Providing and fixing in position. (as per I.S.1868 / 1982) Aluminium sliding window of two tracks						
No.7:-	with rectangular pipe having overall dimension 63.50 x 38.10 x 1.02 mm at weight 0.547						
	7	x	1.50	x	1.65	=	<u>17.33</u>
							17.33 Sqm.

Item No.8:- Providing and applying two coats of flat oil paint of approved colour to the old structural steel work and iron work previously painted in building including scaffolding, if necessary,
 $7 \times 1.50 \times 1.65 = \frac{17.33}{17.33 \text{ Sqm.}}$

Item No.9:- Providing and fixing solid core flush door shutter in single leaf 32 mm thick decorative type of exterior grade as per detailed drawings approved face veneers 3 mm thick on both faces or as directed, all necessary beads, mouldings and lipping, wrought iron hold fasts, chromium plated fixtures and fastenings, with brass mortise lock, chromium plated handles on both sides, and finishing with French Polish etc. complete.
 $1 \times 1.20 \times 2.40 = \frac{2.88}{2.88 \text{ Sqm.}}$

Item No.10:- Providing computer table etc. complete.
 $100.00 = 100.00 \text{ Nos.}$

**NAME OF WORK :- DEVELOPMENT OF COMPOUTER LAB FOR PG OF YESHWANT MAHAVIDYALAYA,
NANDED**

ELECTRICAL WORK

ITEM NO.	DISCRPTION	Unit	Qty.	Rate	Total Amount in Rs.
1-1-10.	Supplying and laying HMS PVC conduit FRLS grade 25 mm dia with necessary accessories in RCC	Mtr.	35	117	4095.00
1-2-1.	Supplying and erecting 20mm dia. corrugated flexible polypropylene conduit	Mtr.	10	16	160.00
1-2-7.	Supplying and erecting PVC trunking (PVC casing-n-capping) of size 25 mm	Mtr.	10	44	440.00
1-2-9.	Supplying and erecting PVC trunking (PVC casing-n-capping) of size 40 mm	Mtr.	15	81	1215.00
1-3-1.	Supplying and erecting mains with 2x1.5 sq.mm FRLSH copper PVC insulated wire	Mtr.	896	40	35840.00
1-3-4.	Supplying and erecting mains with 2x6 sq.mm FRLSH copper PVC insulated wire	Mtr.	120	132	15840.00
1-3-5.	Supplying and erecting mains with 2x10 sq.mm FRLSH copper PVC insulated wire	Mtr.	30	232	6960.00
1-3-6.	Supplying and erecting mains with 3x2.5 sq.mm FRLSH copper PVC insulated wire	Mtr.	364	93	33852.00
1-6-11.	Supplying and erecting modular type 3 pin 6 / 16A multi socket with safety shutter, duly erected on provided plate and box with wiring connections complete.	Each	96	160	15360.00
1-6-23.	Supplying and erecting modular type (two module) electronic step regulator for fan	Each	9	382	3438.00
1-7-16.	Point wiring for ceiling fan (Surface type under false ceiling and concealed type for drops & switch boards on walls) in min 20 mm PVC conduit	Point	9	638	5742.00
1-7-19.	Point wiring for light/bell/exhaust fan in PVC trunking (casing-capping) with 1.5 sq.mm.	Point	17	552	9384.00
1-7-26.	Wiring for plug on board with Switch socket surface/concealed type, copper wiring and earthing and with modular accessories as per specification No: WGPW/CW	Point	96	386	37056.00
2-1-7.	Supplying and erecting LED Panel Light(600mm X 600mm) Max. 30 W	Each	6	2524	15144.00
2-1-18.	Supplying and erecting anodized aluminium corridor / passage light LED fitting (4 feet) Max. 22W	Each	2	797	1594.00
2-10-21.	Supplying and erecting energy saving ceiling fan 230 V A.C. 50 cycles 1200 mm	Each	9	2397	21573.00
2-11-4.	Supplying and erecting fan hook of 10 mm.	Each	9	115	1035.00

5-3-2.	Supplying, erecting & marking SPMCB 6A to 32A	Each	4	174	696.00
5-4-1.	Supplying & erecting triple pole and neutral distribution board (TPNDB)	Each	1	2356	2356.00
5-4-16.	Supplying & erecting triple pole and neutral distribution board (TPNDB), 3 pole/4 pole MCCB	Each	2	7791	15582.00
5-5-2.	Providing & erecting 3 Pole MCCB, 415V, 200A	Each	1	10604	10604.00
9-1-1.	Providing earthing with galvanized iron earth plate size 60 x 60 x 0.6 cm complete with all materials, testing & recording the results as per specification no. EA-EP	Each	1	4714	4714.00
1-6-30.	PVC Surface 6 Mod. Switch Box	Each	6	222	1332.00
2-10-15.	Exhaust Fan 225 mm. AC 230 Volt	Each	2	2032	4064.00
5-3-12.	FPMCB 6 Amp. To 32 Amp	Each	2	1059	2118.00
5-3-13.	FPMCB 40 Amp. To 63 Amp	Each	2	1329	2658.00
				Total Rs	252852.00



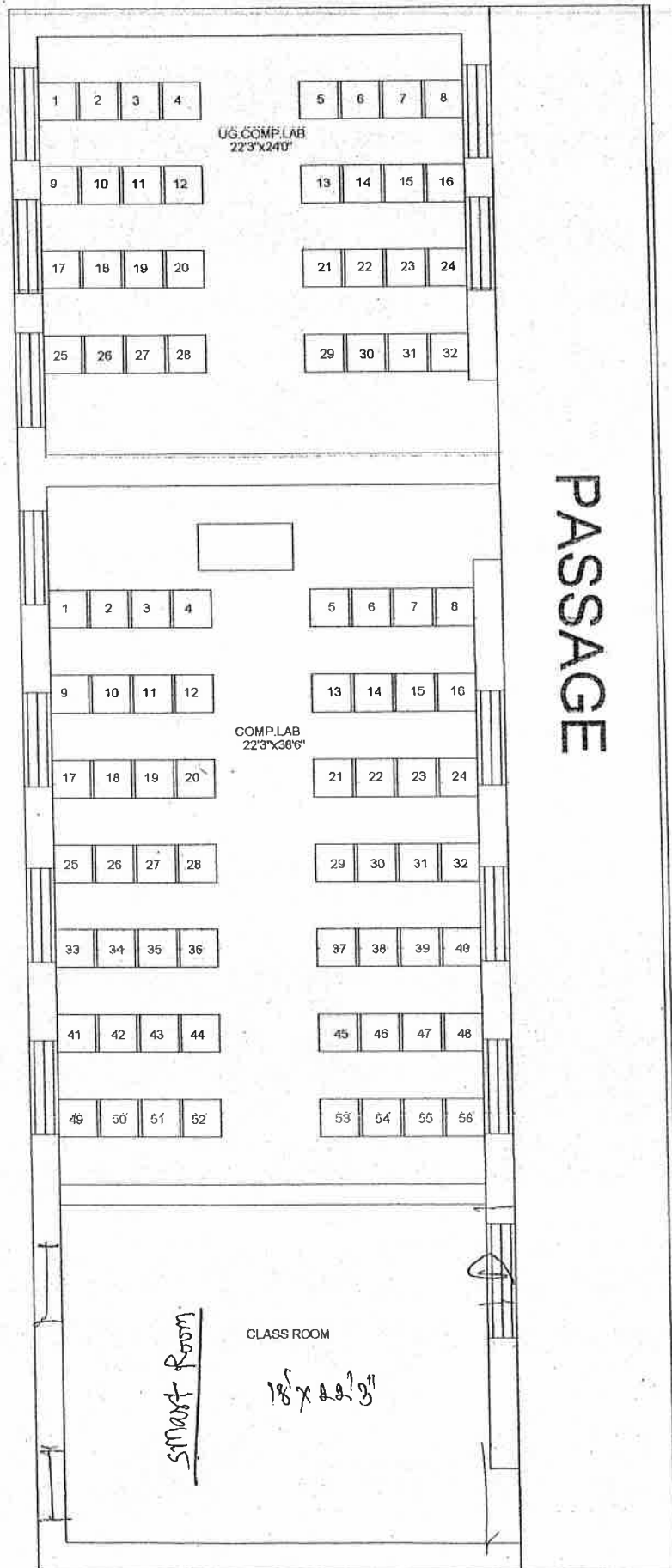

PASSAGE

FRIST FLOOR

COMPUTER LAB
FOR YESHWANT MAHAVIDYALAYA, NANDED

NAME OF WORK :- DEVELOPMENT OF COMPUTER LAB FOR UG AND SMART ROOM OF YESHWANT MAHAVIDYALAYA, NANDED

ABSTRACT SHEET

Item	Description of Item	Qty	Unit	Rate		Amount
1	Removing cement tiles, or marble or polished shahabad floor or dado without bed concrete	87.04	Sqm.	40.00	Rs.	3482.00
3	Removing ventilators and small windows with frame and stacking the materials with all leads, lifts etc. complete.	8.00	Sqm.	132.00	Rs.	1056.00
4	Providing and laying in position flooring of telephone black / Amba White / Cat bary brown / Ruby red / Ocean Brown granite stone of approved shade and size 18 mm to 20 mm thick on bed 1:6 cement mortar including	5.81	Sqm.	4024.00	Rs.	23359.00
5	Providing & Fixing in position, Acoustical Ceiling made from Gypsum Plain Panels on approved heavy duty G.I. frame ceiling channels at 450 c to c, & intermediate channels not more than 1200 c to c, along with ply	87.04	Sqm.	1465.00	Rs.	127514.00
6	Providing and laying vitrified mirror / glossy finish tiles decorative type having size 590 mm to 605 mm x 590 mm to 605 mm of 8 to 10 mm thickness and	92.32	Sqm.	1177.00	Rs.	108661.00
7	Providing and applying Two coats of wall care Putty on plastered surface and Ceiling and Walls to prepare surface	144.68	Sq.M.	90.00	Rs.	13021.00
8	Providing, fabricating and erecting at site of work the	0.20	MT	114831.00	Rs.	22415.00
9	Providing and applying plastic emulsion paint of approved quality, colour and shade to old and new surfaces in two coats	144.68	Sqm.	80.00	Rs.	11574.00
10	Providing and fixing in position. (as per I.S.1868 / 1982) Aluminium sliding window of two tracks with rectangular pipe having overall dimension 63.50	17.33	Sqm.	5479.00	Rs.	94924.00

11	Providing and applying two coats of flat oil paint of approved colour to the old structural steel work and iron work previously painted in building including scaffolding, if necessary,	5.76	Sqm.	85.00	Rs.	490.00
12	Providing and fixing solid core flush door shutter in single leaf 32 mm thick decorative type of exterior grade as per detailed drawings approved face veneers	2.88	Sqm.	3079.00	Rs.	8868.00
13	Providing computer table etc. complete.	2.00	No	7000.00	Rs.	14000.00
Total					Rs.	429364.00
Add GST 18%					Rs.	77286.00
Sub - Total					Rs.	506650.00

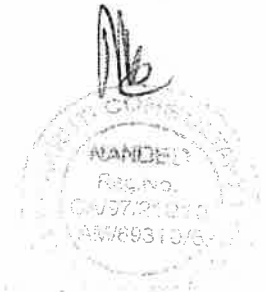

**NAME OF WORK :- DEVELOPMENT OF COMPOUTER LAB FOR UG AND SMART
ROOM OF YESHWANT MAHAVIDYALAYA, NANDED**

MEASUREMENT SHEET

Item	Removing cement tiles, or marble or polished shahabad floor or dado without bed concrete						
No.1 :-	including stacking the materials as directed with all leads, lifts etc. complete						
	1	x	6.80	x	7.30	=	49.64
	1	x	6.80	x	5.50	=	37.40
							<u>87.04 Sq.M.</u>
Item	Removing ventilators and small windows with frame and stacking the materials with all leads, lifts						
No 3 :-	etc. complete.						
	8	x	1.00	x	1.00	=	8.00
							<u>8.00 No</u>
Item	Providing and laying in position flooring of telephone black / Amba White / Cat bary brown / Ruby						
No.4 :-	red / Ocean Brown granite stone of approved shade and size 18 mm to 20 mm thick on bed 1:6 cement mortar including cement floats striking joints, pointing in C.M. 1:3 curing and cleaning etc. complete.						
Window	7	x	1.00	x	0.45	x	1.5 = 4.73
Door	2	x	1.00	x	0.45	x	1.2 = 1.08
							<u>5.81 Cum.</u>
Item	Providing & Fixing in position, Acoustical Ceiling made from Gypsum Plain Panels on approved						
No.5 :-	heavy duty G.I. frame ceiling channels at 450 c to c, & intermediate channels not more than 1200 c to c, along with ply wood forms suspended with Hangers from Roof, in front of 1000 Gsm synthetic wool 50 mm thick, with Paint, including cost of required Cut-Outs, decorative mouldings / finishing-items & Scaffolding, as per Architectural & Acoustical Design & Instructions & Complete in all aspects.including all materials labour,finishing etc complete						
	1	x	6.80	x	7.30	=	49.64
	1	x	6.80	x	5.50	=	37.40
							<u>87.04 Sq.M.</u>
Item	Providing and laying vitrified mirror / glossy finish tiles decorative type having size 590 mm to						
No.6 :-	605 mm x 590 mm to 605 mm of 8 to 10 mm thickness and confirming to IS. 15622-2006 (group Bl) of approved make, shade and pattern for flooring in required position laid on a bed of 1:4						
	1	x	6.80	x	7.30	=	49.64
	1	x	6.80	x	5.50	=	37.40
	2	x	6.80	x	0.10	=	1.36
	2	x	7.30	x	0.10	=	1.46
	2	x	6.80	x	0.10	=	1.36
	2	x	5.50	x	0.10	=	1.10
							<u>92.32 Cum.</u>
Item	Providing and applying Two coats of wall care Putty on plastered surface and Ceiling and						
No.7:-	Walls to prepare surface even and smooth of approved make, etc complete.						
	4.00	x	6.80	x	3.10	=	84.32
	2.00	x	7.30	x	3.10	=	45.26
	2.00	x	5.50	x	3.10	=	34.10
	7	x	3.00	x	1.50	x	0.45 = 2.03
	2	x	1.00	x	1.20	x	0.40 = 0.48
							<u>166.19 Sq.m.</u>
Deduction							
	1	x	7.00	x	1.50	x	1.50 = 15.75
	1	x	2.00	x	1.20	x	2.40 = 5.76
							<u>21.51 Sq.m.</u>
						Net Qty =	144.68 Sq.m.

Item Providing, fabricating and erecting at site of work the tubular steel structure (shed) as per
No.8:- standard design and specifications having various spans in between trusses and in multiples of

Pipe for ceiling	1	x	2.00	x	4.00	x	3.50	=	28.00
	1	x	2.00	x	4.00	x	2.60	=	20.80
									48.80

48.80	4.00	195.20 Kg
		0.20 MT

Item Providing and applying plastic emulsion paint of approved quality, colour and shade to old and
No.09:- new surfaces in two coats including scaffolding, preparing the surface. (excluding the

Qty. As per putty	=	<u>144.68</u>
		144.68 Sqm.

Item Providing and fixing in position. (as per I.S.1868 / 1982) Aluminium sliding window of two tracks
No.10:- with rectangular pipe having overall dimension 63.50 x 38.10 x 1.02 mm at weight 0.547

7	x	1.50	x	1.65	=	<u>17.33</u>
						17.33 Sqm.

Item Providing and applying two coats of flat oil paint of approved colour to the old structural steel
No.11:- work and iron work previously painted in building including scaffolding, if necessary,

2	x	1	x	1.20	x	2.40	=	<u>5.76</u>
								5.76 Sqm.

Item Providing and fixing solid core flush door shutter in single leaf 32 mm thick decorative type of
No.12:- exterior grade as per detailed drawings approved face veneers 3 mm thick on both faces or as directed, all necessary beads, mouldings and lipping, wrought iron hold fasts, chromium plated fixtures and fastenings, with brass mortise lock, chromium plated handles on both sides, and finishing with French Polish etc. complete.

1	x	1.20	x	2.40	=	<u>2.88</u>
						2.88 Sqm.

Item Providing computer table etc. complete.
No.13:-

2.00	=	2.00 Nos.
------	---	-----------





NAME OF WORK :- DEVELOPMENT OF COMPOUTER LAB FOR UG AND SMART ROOM OF YESHWANT MAHAVIDYALAYA, NANDED

ELECTRICAL WORK

ITEM NO.	DISCRIPTION	Unit	Qty.	Rate	Total Amount in Rs.
1-1-10.	Supplying and laying HMS PVC conduit FRLS grade 25 mm dia with necessary accessories in RCC	Mtr.	20	117	2340.00
1-2-1.	Supplying and erecting 20mm dia. corrugated flexible polypropylene conduit	Mtr.	5	16	80.00
1-2-7.	Supplying and erecting PVC trunking (PVC casing-n-capping) of size 25 mm	Mtr.	15	44	660.00
1-2-9.	Supplying and erecting PVC trunking (PVC casing-n-capping) of size 40 mm	Mtr.	7	81	567.00
1-3-1.	Supplying and erecting mains with 2x1.5 sq.mm FRLSH copper PVC insulated wire	Mtr.	380	40	15200.00
1-3-4.	Supplying and erecting mains with 2x6 sq.mm FRLSH copper PVC insulated wire	Mtr.	65	132	8580.00
1-3-5.	Supplying and erecting mains with 2x10 sq.mm FRLSH copper PVC insulated wire	Mtr.	15	232	3480.00
1-3-6.	Supplying and erecting mains with 3x2.5 sq.mm FRLSH copper PVC insulated wire	Mtr.	22	93	2046.00
1-6-11.	Supplying and erecting modular type 3 pin 6 / 16A multi socket with safety shutter, duly erected on provided plate and box with wiring connections complete.	Each	42	160	6720.00
1-6-23.	Supplying and erecting modular type (two module) electronic step regulator for fan	Each	6	382	2292.00
1-7-16.	Point wiring for ceiling fan (Surface type under false ceiling and concealed type for drops & switch boards on walls) in min 20 mm PVC conduit	Point	6	638	3828.00
1-7-19.	Point wiring for light/bell/exhaust fan in PVC trunking (casing-capping) with 1.5 sq.mm.	Point	37	552	20424.00
1-7-26.	Wiring for plug on board with Switch socket surface/concealed type, copper wiring and earthing and with modular accessories as per specification No: WGPW/CW	Point	32	386	12352.00
2-1-7.	Supplying and erecting LED Panel Light(600mm X 600mm) Max. 30 W	Each	4	2524	10096.00
2-1-18.	Supplying and erecting anodized aluminium corridor / passage light LED fitting (4 feet) Max. 22W	Each	2	797	1594.00
2-10-21.	Supplying and erecting energy saving ceiling fan 230 V A.C. 50 cycles 1200 mm	Each	4	2397	9588.00
2-11-4.	Supplying and erecting fan hook of 10 mm.	Each	6	115	690.00
5-3-2.	Supplying, erecting & marking SPMCB 6A to 32A	Each	2	174	348.00

5-4-1.	Supplying & erecting triple pole and neutral distribution board (TPNDB)	Each	1	2356	2356.00
5-4-16.	Supplying & erecting triple pole and neutral distribution board (TPNDB), 3 pole/4 pole MCCB	Each	1	7791	7791.00
5-5-2.	Providing & erecting 3 Pole MCCB, 415V, 200A	Each	1	10604	10604.00
9-1-1.	Providing earthing with galvanized iron earth plate size 60 x 60 x 0.6 cm complete with all materials, testing & recording the results as per specification no. EA-EP	Each	1	4714	4714.00
1-6-30.	PVC Surface 6 Mod. Switch Box	Each	6	222	1332.00
2-10-15.	Exhaust Fan 225 mm. AC 230 Volt	Each	2	2032	4064.00
5-3-12.	FPMCB 6 Amp. To 32 Amp	Each	2	1059	2118.00
5-3-13.	FPMCB 40 Amp. To 63 Amp	Each	1	1329	1329.00
				Total Rs	135193.00

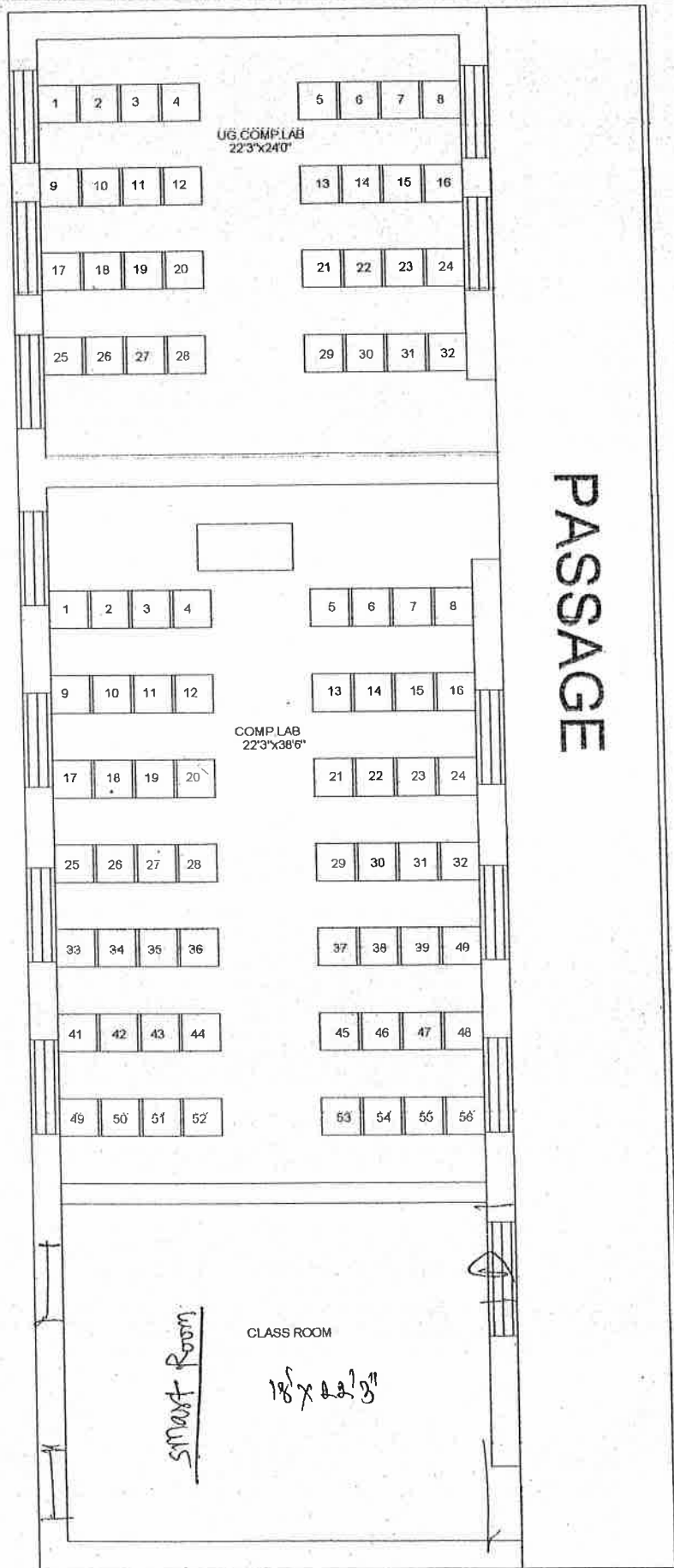

PASSAGE

FRIST FLOOR

COMPUTER LAB
FOR YESHWANT MAHAVIDYALAYA, NANDED